

# DATA SHEET: C SERIES - EXPLOSION PROOF

## PRODUCT DESCRIPTION

Patriot C-SERIES EXPLOSION PROOF LIGHT can be used as spot light, down light and tunnel light which can provide general illumination in hazardous locations.

Our PATRIOT C-SERIES EXPLOSION PROOF LED LIGHTS are backed with our industry-leading 150,000-hour rated lamp life and 10-year warranty. See Ordering Model table below for our BAA compliant products. Contact us for pricing or more information.

### PRODUCT BENEFITS

- High efficacy: up to 140lm/W.
- CRI>80.
- Surface mounting and pendant installations.
- Wide and narrow optics for uniform illumination.
- Copper free aluminum.
- High vibration resistance.
- Limited Warranty: 5 year (10yrs optional).
- Long life LEDs lasting up to 150,000 hours.



### BEAM ANGLE

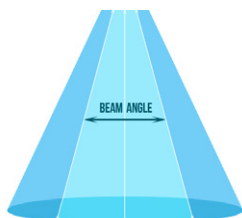

Patriot LED Light Distribution

### CAN DECREASE ENERGY USAGE BY

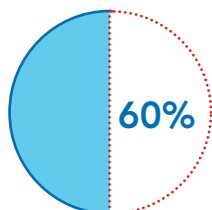

vs. Similar Fluorescent Lamps

### WARRANTY



Our Industry-Leading 10-Year Limited Warranty Guarantees Unsurpassed Quality

### APPLICATIONS

- Refinery factory, Oil and gasoline loading docks.
- Gas stations.
- Painting manufacture workshop.
- Pumping stations, Metal Smelting Plant.
- Mining, Ocean platform.
- Aerospace.
- Chemical plant, Vessels.
- Military.
- Flourmill.
- Distilleries.
- Power station.
- Other high humidity, high temperature, dusty, locations...



## ORDERING MODEL

PATRIOT TUBE	WATTAGE	CCT	VOLTAGE	BEAM ANGLE	WORKING HOURS
PT	60W, 80W, 100W, 120W, 150W, 180W, 200W, 220W, 240W	4000K 5700K	AC100-277V or AC200-480V	60°, 90°, 110°, 140°	Long life LEDs lasting up to 150,000 hours.
Product Code: Example					
Example: PT-60WCYZDA					

"C"=Product series "Y"=D or N:Dimmable or non-dimmable "Z"= CCT, from 4000~5700K "D"=Beam angle: 60°, 90°, 110°, 140°

## PRODUCT SPECIFICATION

Product No.	BAA/TAA Option*	Rated Lamp Wattage	Color Temp (K)	CRI	Efficacy	Rated Lumens	Rated Life (Hours)	Beam Angle
<b>AC100-277V, C SERIES EXPLOSION PROOF</b>								
PT-60WCYZDA	Yes	60W	4000K/5700K	>80	up to 140lm/W	8400	L70 rating for more than 150,000 hours	60° / 90° / 110° / 140°
PT-80WCYZDA	Yes	80W	4000K/5700K	>80	up to 140lm/W	11200	L70 rating for more than 150,000 hours	60° / 90° / 110° / 140°
PT-100WCYZDA	Yes	100W	4000K/5700K	>80	up to 140lm/W	14000	L70 rating for more than 150,000 hours	60° / 90° / 110° / 140°
PT-120WCYZDA	Yes	120W	4000K/5700K	>80	up to 140lm/W	16800	L70 rating for more than 150,000 hours	60° / 90° / 110° / 140°
<b>AC200-480V, C SERIES EXPLOSION PROOF</b>								
PT-150WCYZDA	Yes	150W	4000K/5700K	>80	up to 140lm/W	21000	L70 rating for more than 150,000 hours	60° / 90° / 110° / 140°
PT-180WCYZDA	Yes	180W	4000K/5700K	>80	up to 140lm/W	25200	L70 rating for more than 150,000 hours	60° / 90° / 110° / 140°
PT-200WCYZDA	Yes	200W	4000K/5700K	>80	up to 140lm/W	28000	L70 rating for more than 150,000 hours	60° / 90° / 110° / 140°
PT-220WCYZDA	Yes	220W	4000K/5700K	>80	up to 140lm/W	30800	L70 rating for more than 150,000 hours	60° / 90° / 110° / 140°
PT-240WCYZDA	Yes	240W	4000K/5700K	>80	up to 140lm/W	33600	L70 rating for more than 150,000 hours	60° / 90° / 110° / 140°

## PHYSICAL DATA

Product No.	Material Usage	Size	Certification
<b>AC100-277V, C SERIES EXPLOSION PROOF</b>			
PT-60WCYZDA	Copper free aluminum	16 x 12.7"	UL Classified, NSF
PT-80WCYZDA	Copper free aluminum	16 x 12.7"	UL Classified, NSF
PT-100WCYZDA	Copper free aluminum	16 x 12.7"	UL Classified, NSF
PT-120WCYZDA	Copper free aluminum	16 x 12.7"	UL Classified, NSF
<b>AC200-480V, C SERIES EXPLOSION PROOF</b>			
PT-150WCYZDA	Copper free aluminum	16 x 12.7"	UL Classified, NSF
PT-180WCYZDA	Copper free aluminum	16 x 12.7"	UL Classified, NSF
PT-200WCYZDA	Copper free aluminum	16 x 12.7"	UL Classified, NSF
PT-220WCYZDA	Copper free aluminum	16 x 12.7"	UL Classified, NSF
PT-240WCYZDA	Copper free aluminum	16 x 12.7"	UL Classified, NSF

## RATINGS AND CERTIFICATIONS

- NEMA 4X, IP66.
- UL1598/UL1589A/UL844.
- CSA C22.2 No.137/No.250.0, Class I, Division 2, Groups A,B,C,D, Class II, Division 1, Groups E,F,G, Class II, Division 2, Groups E,F,G, Class III.
- Marine and Wet Locations.
- IECEX.
- ATEX.

## STRUCTURED DIAGRAM

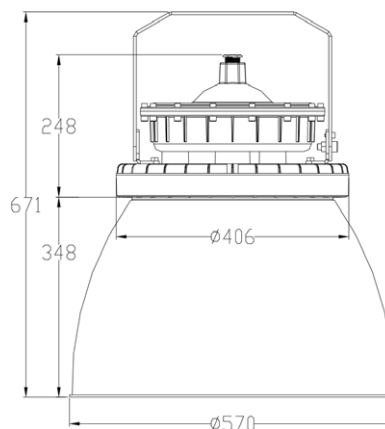

## PROFESSIONAL LIGHT DISTRIBUTION

## FAMILY TREE OF INSTALLATION

Light Distribution Pattern (240W)

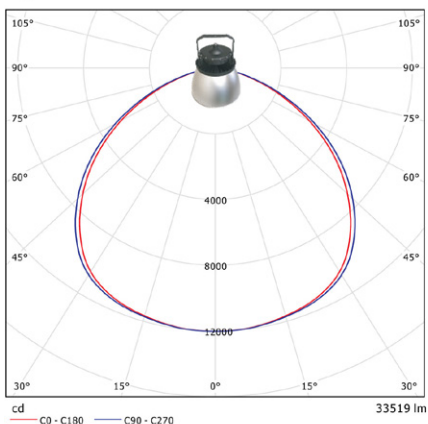

Light intensity curve

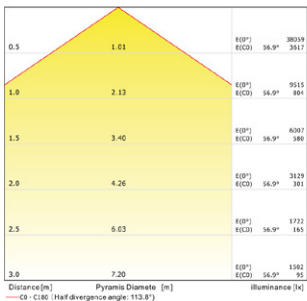

Plane illuminance curve

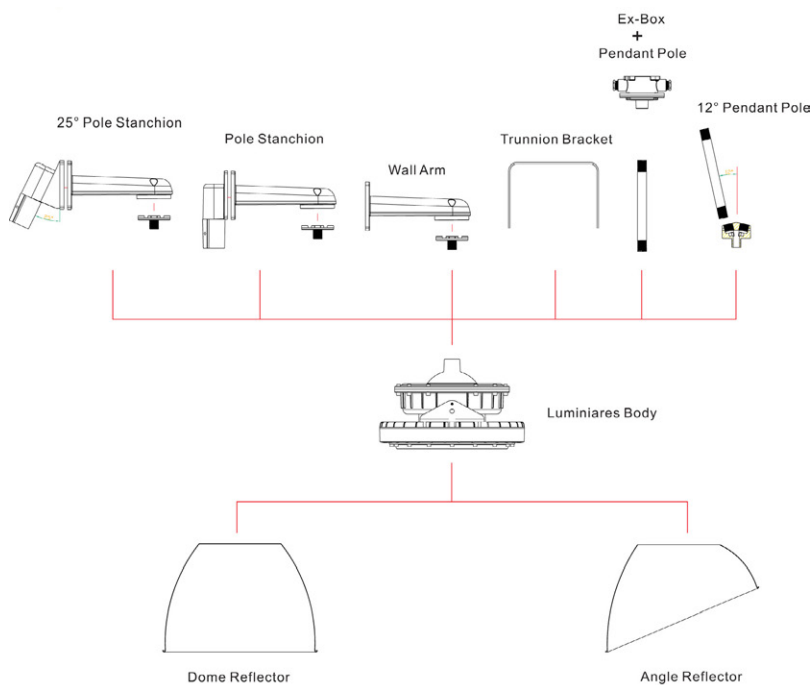
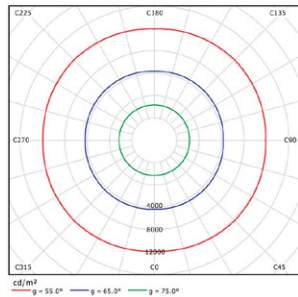

Adaptor	Conduit	Catalog No.
25° Pole Stanchion	3/4" or 1" NPT	25DPS
Pole Stanchion	3/4" or 1" NPT	PS
Wall Arm	3/4" or 1" NPT	WA
Trunnion Bracket	Expand Screw	TB
Pendant Pole	Use Ex-Box	PP
12° Pendant Pole	3/4" or 1" NPT	12DPP
Ex-Box	3/4" NPT	EB